

# Community Facilities Task Force

## Consolidation Simulation

*April 16, 2024*



# Simulation Objectives

- Understand Current Enrollment
- Capacity and Utilization of Facilities
- Task Force Charge

# Simulation Rules

## GRADES PK-5

**OBJECTIVE:** Enroll each student at a school. All 243 blocks must be on the board at the end of the simulation.

There are 24,312 students that attend CCS PK-5 Schools.

243 blocks  
 = 24,312 Students

## GRADES 6-8

**OBJECTIVE:** Enroll each student at a school. All 95 blocks must be on the board at the end of the simulation.

There are 9,443 students that attend CCS Middle Schools.

95 blocks  
 = 9,444 Students

## GRADES 9-12

**OBJECTIVE:** Enroll each student at a school. All 123 blocks must be on the board at the end of the simulation.

There are 12,245 students that attend CCS High Schools.

123 blocks  
 = 12,245 Students

# Simulation Legend

1 block



= 100 Students

Name of the school

# students enrolled at that school

Beechcroft

Dots represent students currently enrolled at a school - place a block to start

# students that live in the attendance area of their home school by address AND attend that school

# students that live in the attendance area of their home school by address

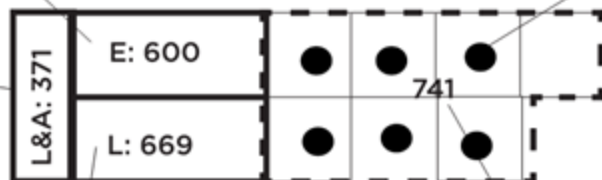

Facility Cost Index as established by OFCC comparing renovation versus building new. Higher % = More Investment Needed

Facility Capacity as established during the 2018 Consolidation Committee using Teaching Work Stations

# Simulation Variances – ‘Parking Lot’

Columbus City Schools can veer from the guidelines if there is a compelling reason to do so. If you have an idea or strategy that falls outside the scope of the simulation, describe your idea, in writing, on the board next to the school or site in question.

# Questions?

